

FYC 510

Material Cast iron

Dimensions

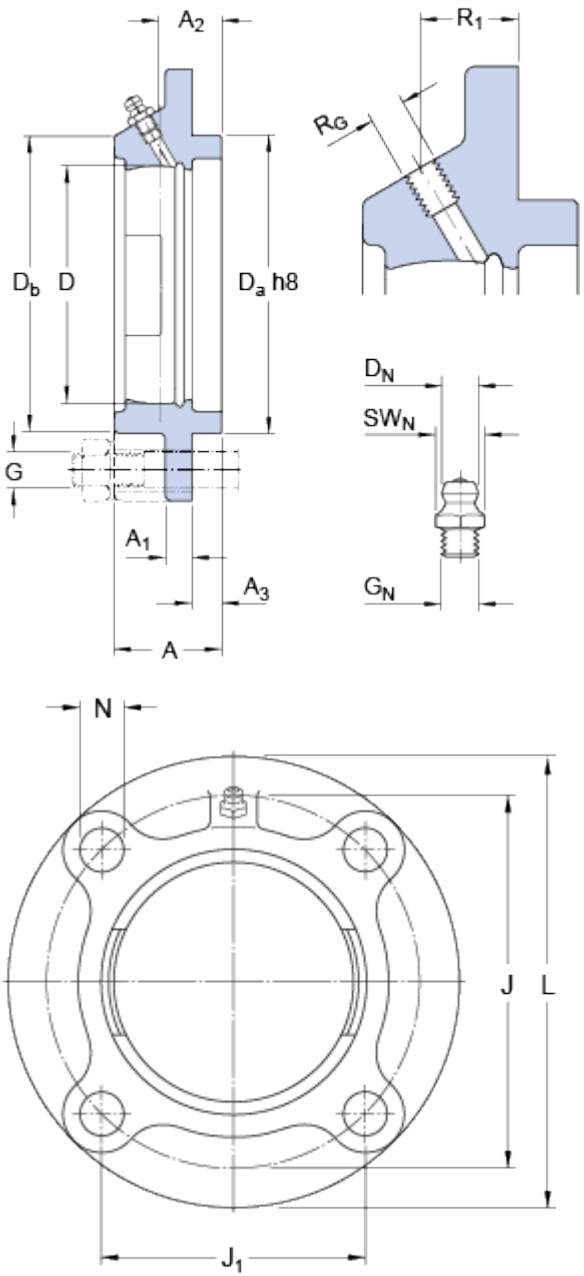

D	90	mm
D _a	110	mm
D _b	113.1	mm
A	39.5	mm
A ₁	14	mm
A ₂	22	mm
A ₃	12	mm
J	138	mm
J ₁	97.6	mm
L	165	mm
N	16	mm
Threaded hole		
R _G	1/4-28 UNF	
R ₁	22	mm
Grease fitting		
D _N	6.5	mm
SW _N	7	mm
G _N	1/4-28 SAE-LT	

Mass

Mass housing 2.15 kg

Mounting information

Recommended diameter for attachment bolts, mm G 14 mm
 Recommended diameter for attachment bolts, inch G 0.5625 in