

FYTB 503 M

Material

Cast iron

Dimensions

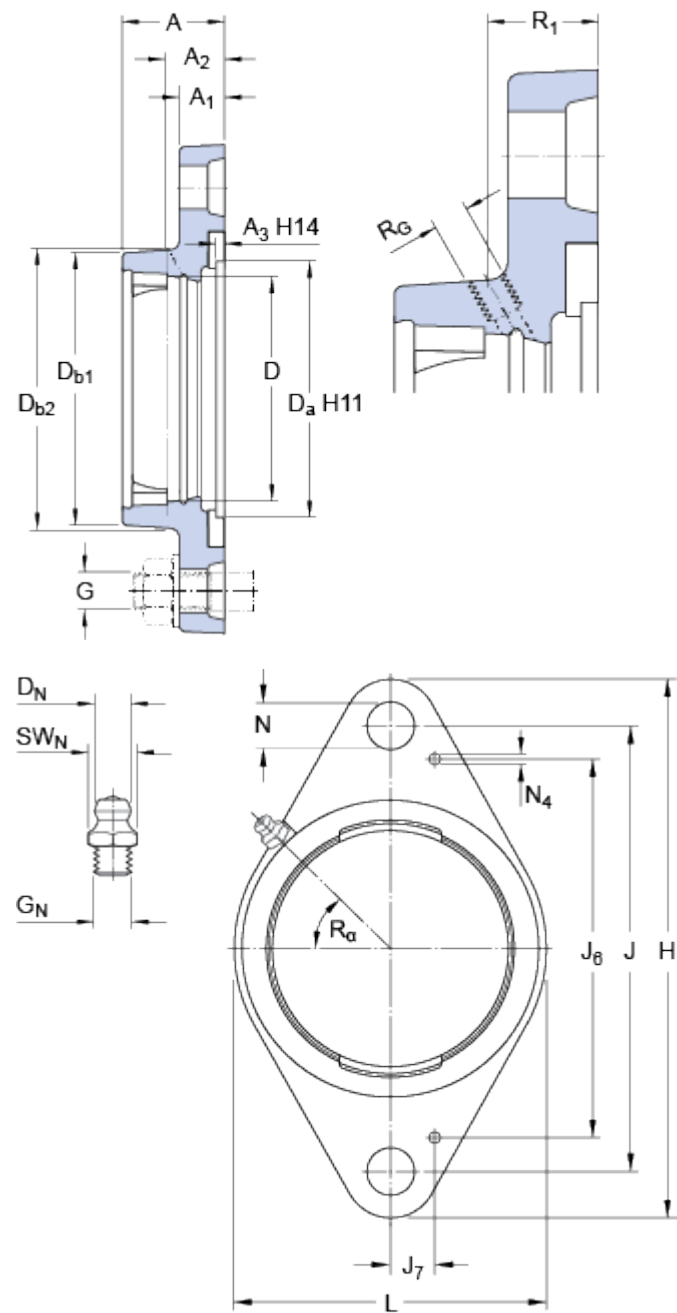

D	40	mm
D _a	50.8	mm
D _{b1}	50	mm
D _{b2}	57	mm
A	26	mm
A ₁	11	mm
A ₂	17	mm
A ₃	3.2	mm
J	76.5	mm
H	98.5	mm
L	57	mm
N	11.5	mm
Threaded hole		
R _G	1/4-28 UNF	
R ₁	19	mm
R _α	45	°
Grease fitting		
D _N	6.5	mm
SW _N	7	mm
G _N	1/4-28 SAE-LT	
Dowel pins		
J ₆	61.5	mm
J ₇	11	mm
N ₄	2	mm

Mass

Mass housing

0.24

kg

Mounting information

Recommended diameter for attachment bolts, mm	G	10	mm
Recommended diameter for attachment bolts, inch	G	0.375	in