

# PF 47

Material

Pressed steel

## Dimensions

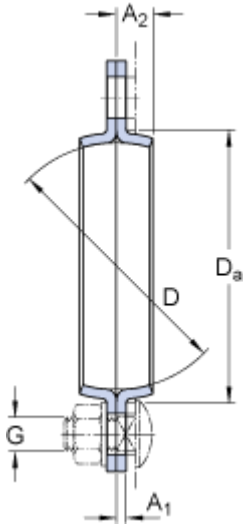

D	47	mm
$D_a$	min. 51	mm
$A_1$	2	mm
$A_2$	8	mm
J	71.4	mm
H	90	mm
N	8.7	mm

## Calculation data

Permissible radial load	max.	3.3	kN
-------------------------	------	-----	----

## Mass

Mass housing	0.16	kg
--------------	------	----

## Mounting information

Recommended diameter for attachment bolts, mm	G	8	mm
Recommended diameter for attachment bolts, inch	G	0.3125	in