

FYTB 45 TF

Compliance with standard

ISO

Housing material

Cast iron

Sealing solution

Standard seals with additional flingers

Dimensions

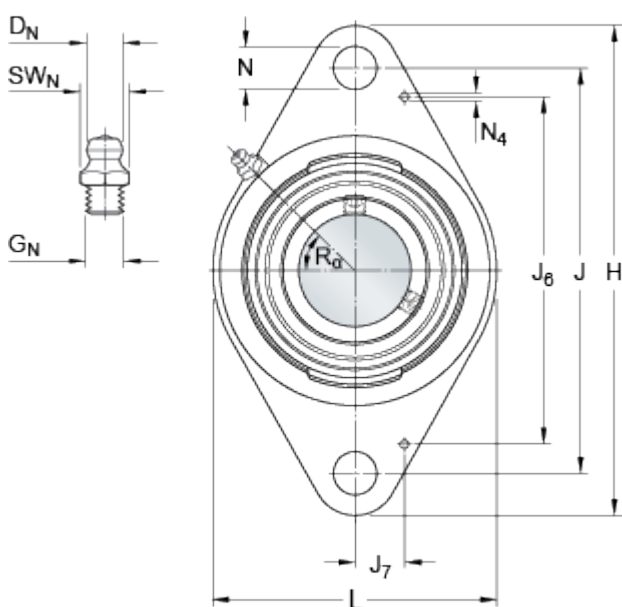
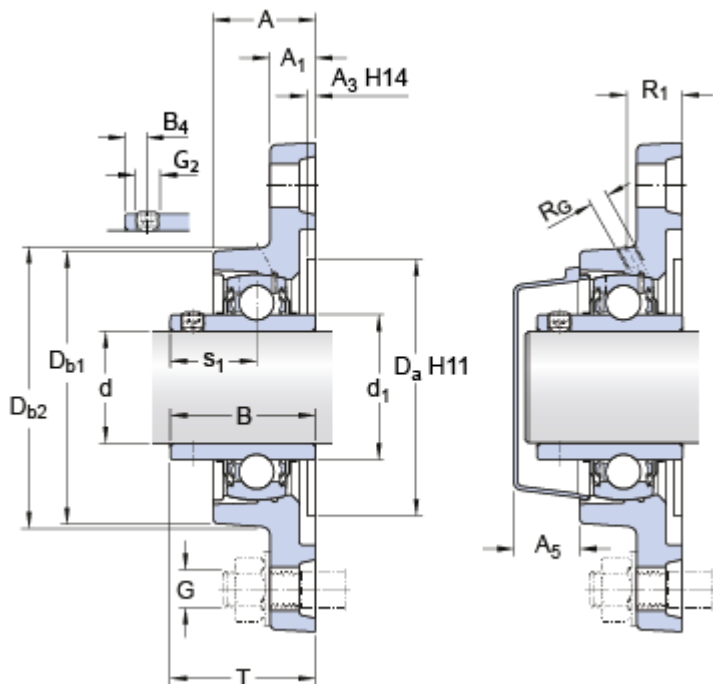

d	45	mm
d ₁	≈ 56.8	mm
D _a	98.4	mm
D _{b1}	102	mm
D _{b2}	111	mm
A	39	mm
A ₁	14	mm
A ₃	3.2	mm
A ₅	26.5	mm
B	49.2	mm
B ₄	8	mm
J	148.5	mm
H	178.5	mm
L	111	mm
N	16	mm
s ₁	30.2	mm
T	54.2	mm

Threaded hole

R _G	1/4-28 UNF	
R ₁	24.5	mm
R _α	45	°

Grease fitting

D _N	6.5	mm
SW _N	7	mm

G_N 1/4-28 SAE-LT

Dowel pins

J₆ 120.5 mm

J₇ 18 mm

N₄ 2 mm

Calculation data

Basic dynamic load rating	C	33.2	kN
Basic static load rating	C ₀	21.6	kN
Fatigue load limit	P _u	0.915	kN
Limiting speed (with shaft tolerance h6)		4300	r/min

Mass

Mass bearing unit		1.7	kg
-------------------	--	-----	----

Mounting information

Thread grub screw	G ₂	M8x1	
Hexagonal key size for grub screw	N	4	mm
Recommended tightening torque for grub screw		6.5	N·m
Recommended diameter for attachment bolts, mm	G	14	mm
Recommended diameter for attachment bolts, inch	G	0.5625	in

Included products

Housing		FYTB 509 M
Bearing		YAR 209-2F

Associated products

End cover		ECY 209
-----------	--	---------